

INSTALLATION SEQUENCE

HALFEN Stone Support Anchor



Each panel is generally fixed at four points. Thermal insulation should be cut out before drilling the anchor hole.

Anchoring in vertical joints

Panels are mostly installed beginning on the left-hand side of the building. Direction of installation: from left to right and from the bottom up. Using suitable bolt – or grout-in anchor according to the approval, install the anchor.



Position the 1st natural stone panel onto the 1st support anchor and wedge the right-hand side.

Starting installation at the left-hand of the building

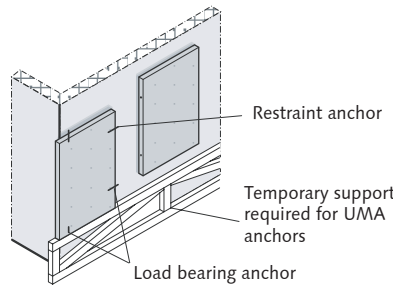

Fasten the support anchor and restraint anchor for the 1st vertical joint and fine-adjust. Re-insert the cut-out thermal insulation so it fits tightly. Push the anchor pin through the bracket and push it into the sliding sleeve. Fill the pin holes of the 2nd natural stone panel with mortar. Then push the 2nd panel up to the 1st panel. Leave a gap of at least 2 mm on one side (sliding sleeve side).



Fit support anchor and restraint anchor, fine-adjust. Installation at the right-hand edge of the building: the second-last panel is anchored at the right-hand edge in the vertical joint with one-way pins. The last natural stone panel at the right-hand edge of the building is placed onto 2 support anchors in the horizontal joint.



Anchoring in horizontal joints

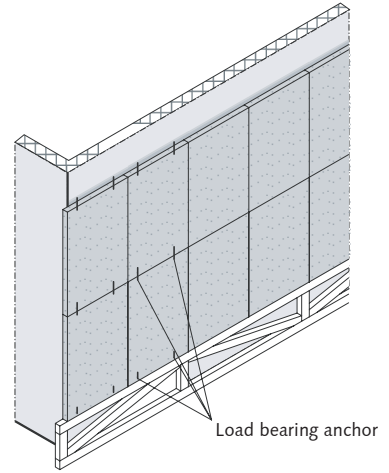

Drill dowel holes for 1st and 2nd row of panel; Align support anchors and fasten with bolts. Re-insert the cut-out thermal insulation so it fits tightly. Fill the pin holes with mortar and place the 1st row of panels on the anchors.

Installation of the last panel on the right-hand edge of the building

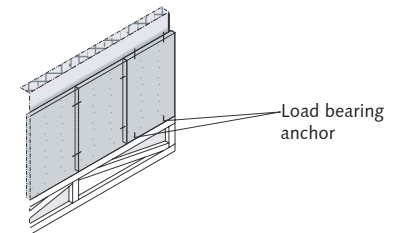

Fasten the support anchors for the 2nd row of panels and fine-adjust the 1st row of panels. Leave a gap of at least 2 mm between the top edge of the panels of the bottom row and the under-side of support anchor of the 2nd row of panels. Push the anchor pin through the bracket into the sliding sleeve below. Position the 2nd row of panels, etc.

Further details are given in DIN 18516, part 3 and in our installation instructions.